



SPRUTCAM X
WORLD CONFERENCE
2023

**The History and
Future of MachineMaker**

SprutCAM X

- Machine axis limits

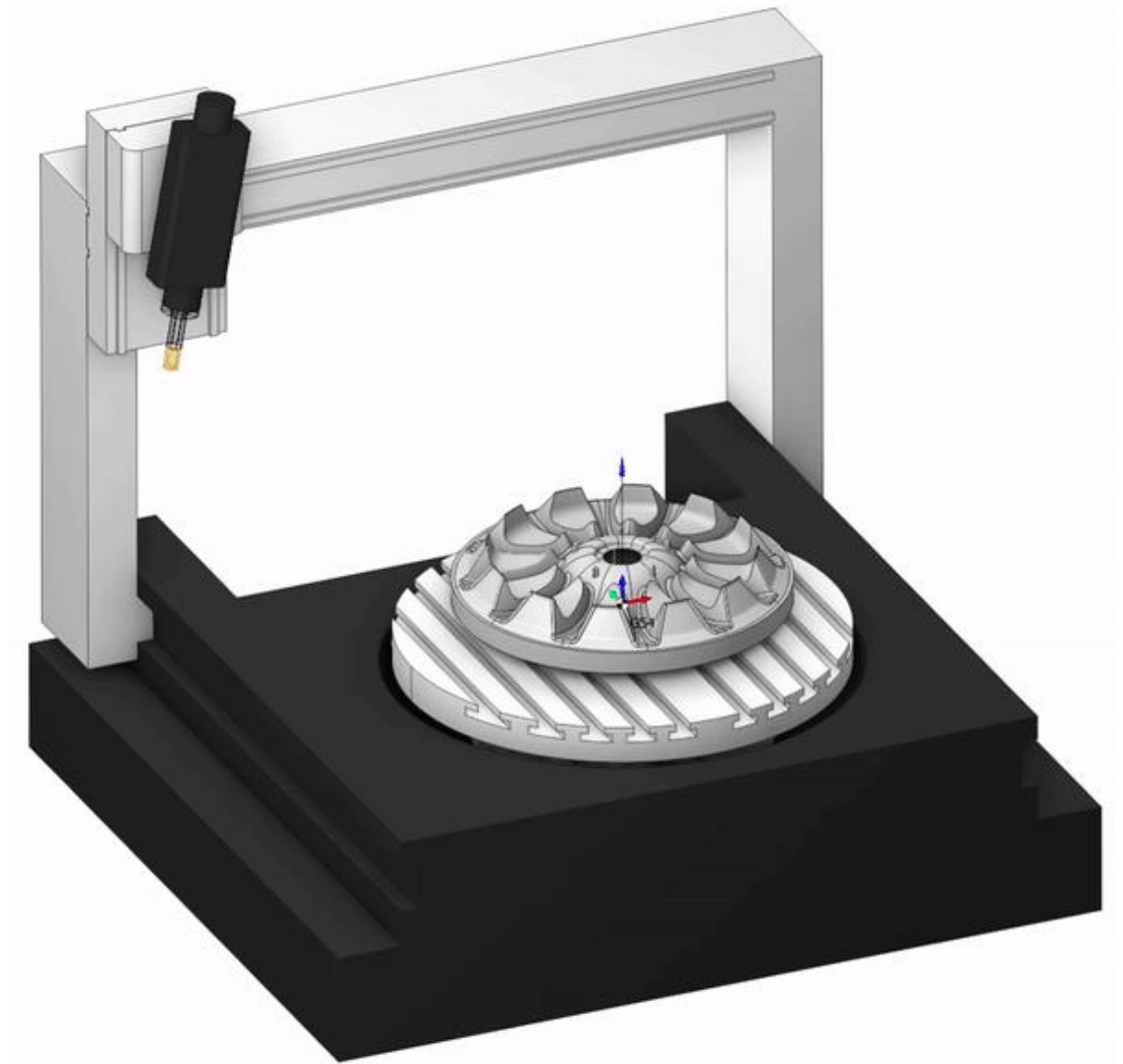

SprutCAM X

- Machine axis limits
- Realistic simulation

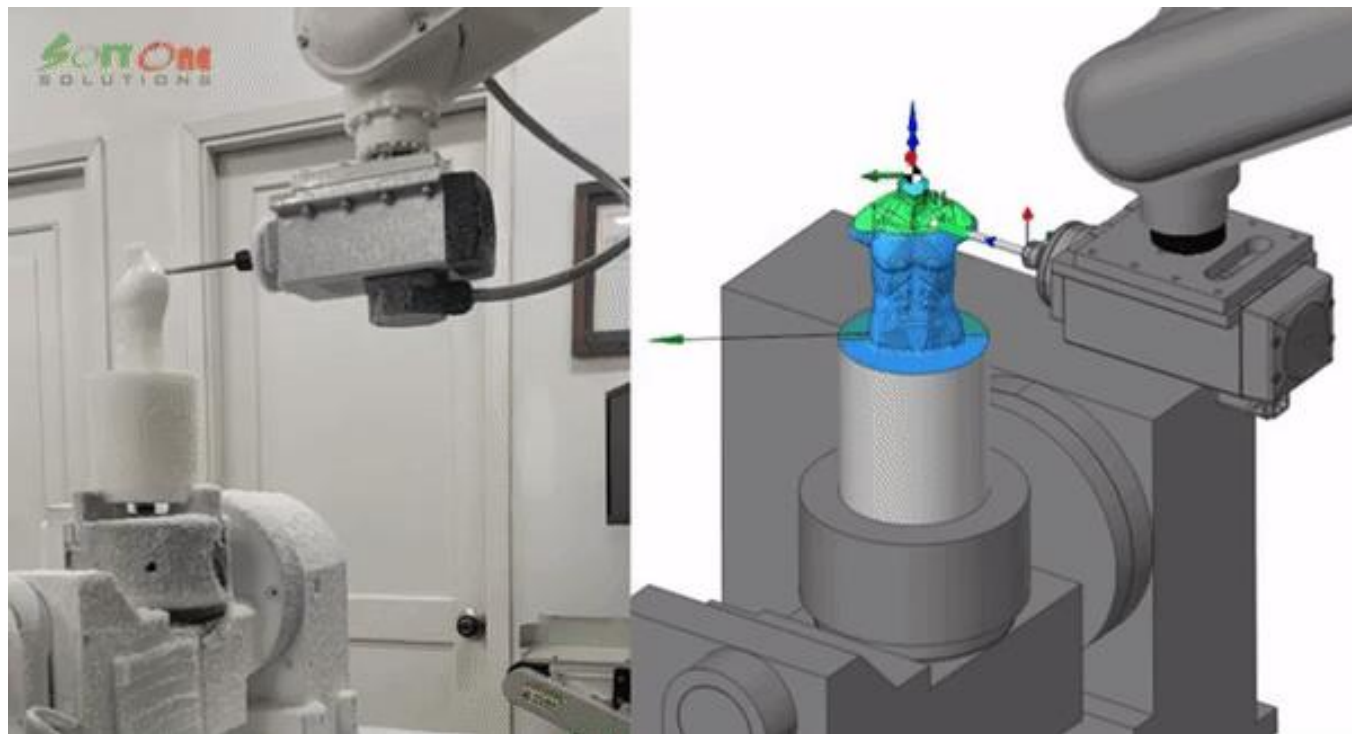

<https://softone.net.vn/>



SprutCAM X

- Machine axis limits
- Realistic simulation
- Detect Collisions
- Avoid collisions

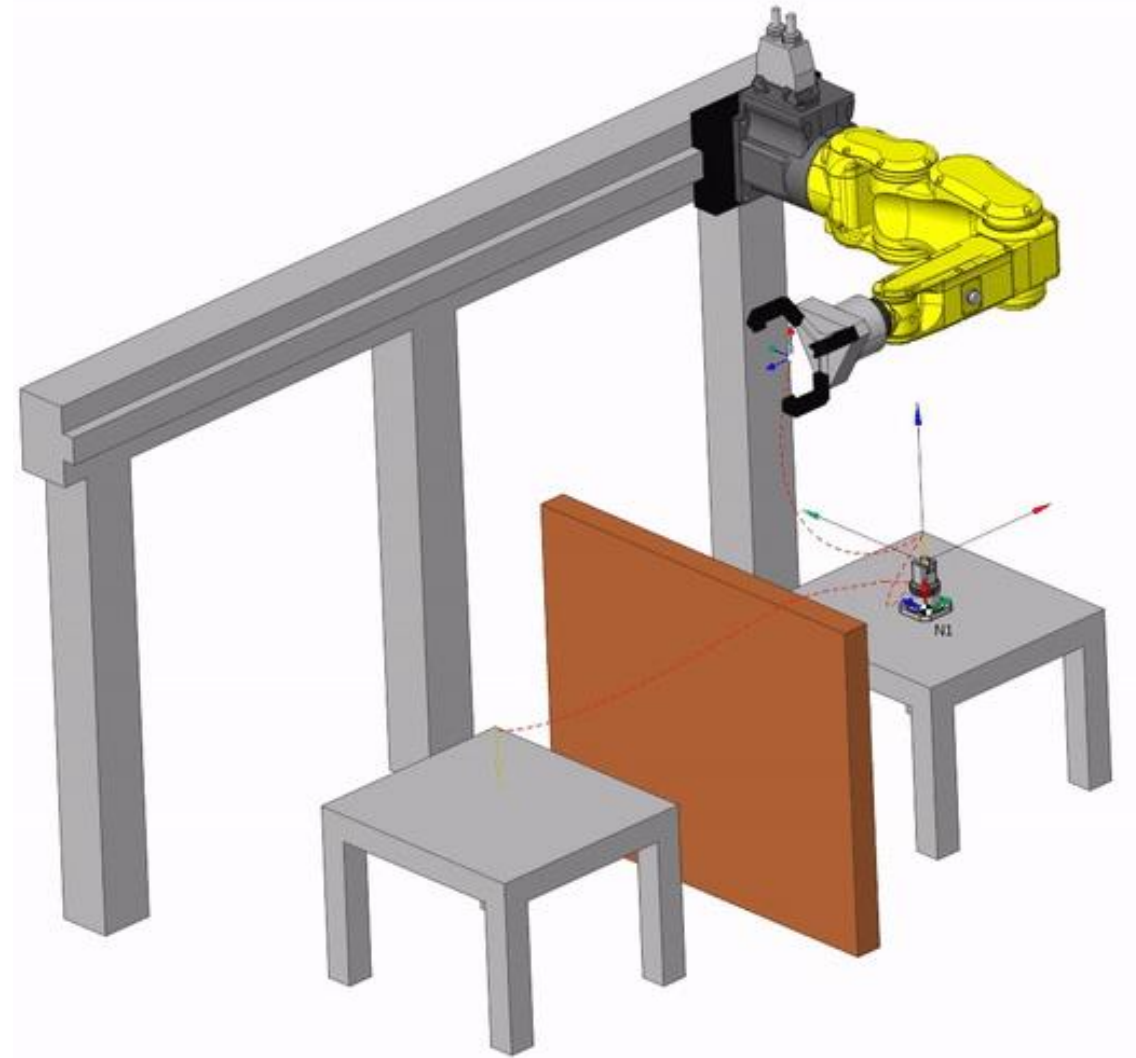

Workflow

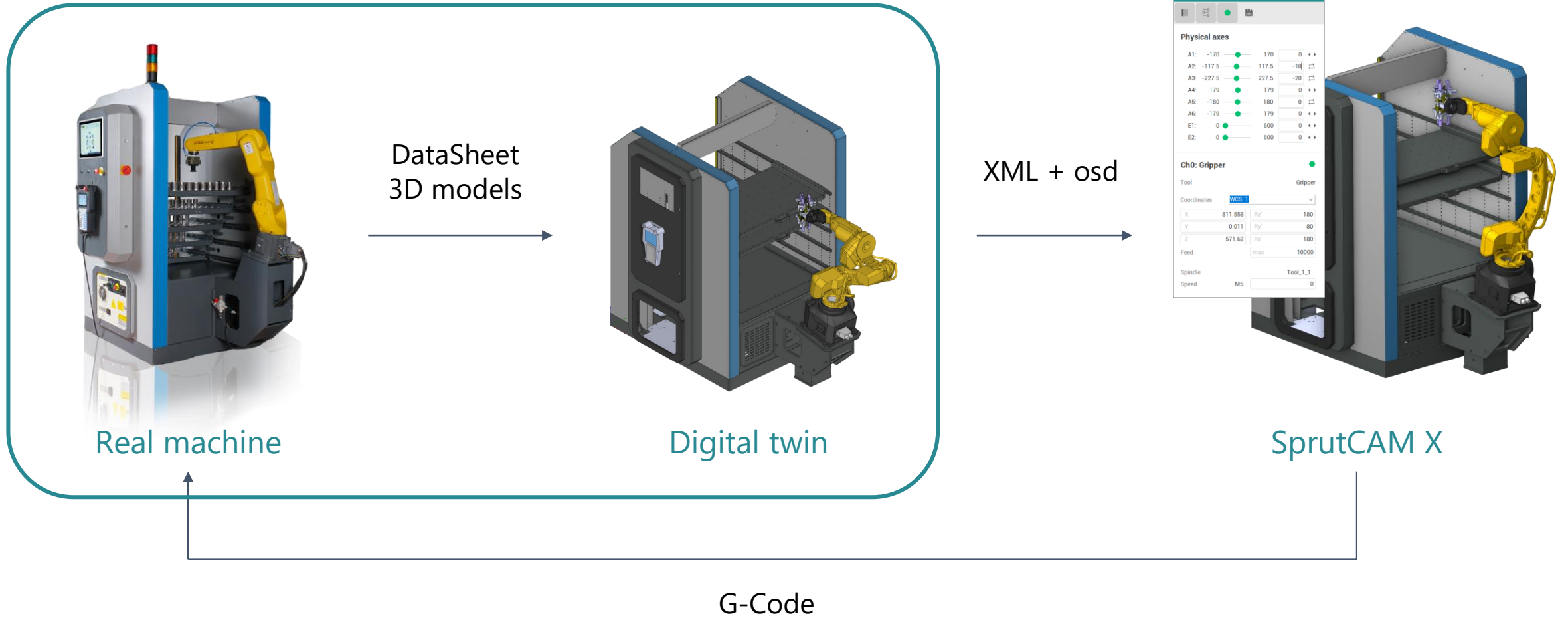

History

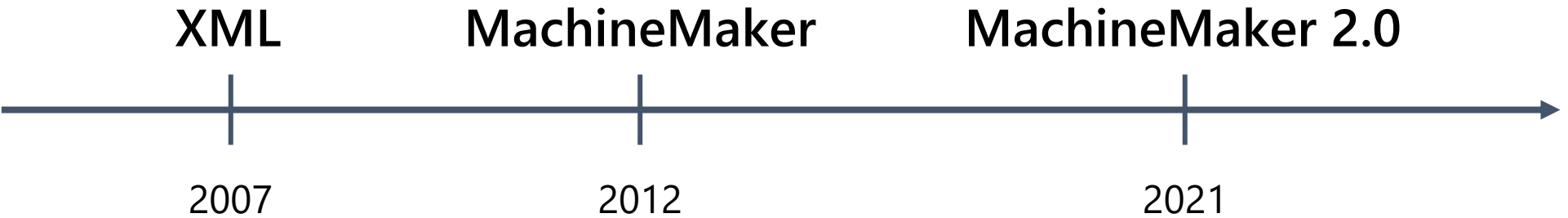

XML

- Powerfull
- Still works
- Extremely hard to learn
- Easy to make mistake
- Hard to find problem

```
<SCType ID="Slovtos" Caption="Slovtos 4-axis" type="AbstractMachine" Enabled="true">
  <GUID DefaultValue="{F916895F-26E0-463E-B29C-995CF58C5C41}" />
  <Priority DefaultValue="132" />
  <Name DefaultValue="Slovtos" />
  <Comment DefaultValue="Slovtos" />
  <Image DefaultValue="Slovtos.jpg" />
  <Icon DefaultValue="Mill_3Axis_ico.bmp" />
  <Group DefaultValue="Milling" />
  <Developer DefaultValue="Slovtos" />
  <ControlData>
    <UseArcInYZ DefaultValue="true" />
    <UseArcInZX DefaultValue="true" />
    <RotaryTrans>
      <PolarAvailable DefaultValue="false" />
      <CNCSupPolar DefaultValue="false" />
      <CylindAvailable DefaultValue="true" />
      <CNCSupCylind DefaultValue="true" />
      <TCPMAvailable DefaultValue="True" />
      <TCPMDefault DefaultValue="False" />
    </RotaryTrans>
  </ControlData>
  <Origin>
    <OriginLCS DefaultValue="WorkpieceLCS" />
    <InitialX DefaultValue="Zero" />
    <InitialY DefaultValue="Zero" />
    <InitialZ DefaultValue="MinZ" />
  </Origin>
  <MachineStateParameters>
    <SCType ID="AxisXPos" type="TAxisXPosition" />
    <SCType ID="AxisYPos" type="TAxisYPosition" />
    <SCType ID="AxisZPos" type="TAxisZPosition">
      <InitialValue DefaultValue="254" />
    </SCType>
  </MachineStateParameters>
  <Schema>
    <ImageFile DefaultValue="Frame.osd" />
    <VisualProperties>
      <Color>
        <R DefaultValue="239/256" />
        <G DefaultValue="243/256" />
        <B DefaultValue="250/256" />
      </Color>
    </VisualProperties>
  </Schema>
</SCType>
```



MachineMaker version 1.0

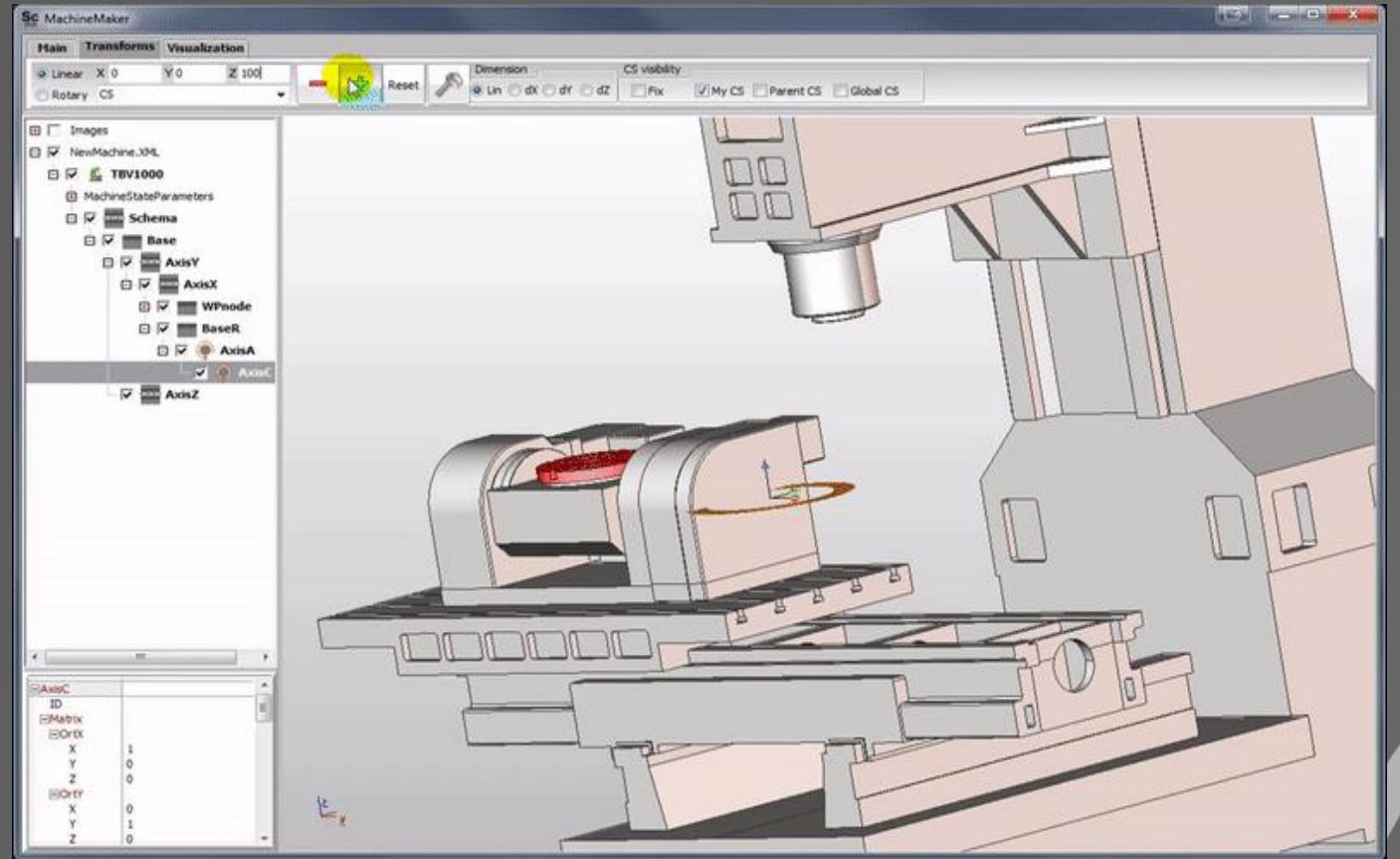



MachineMaker version 2.0

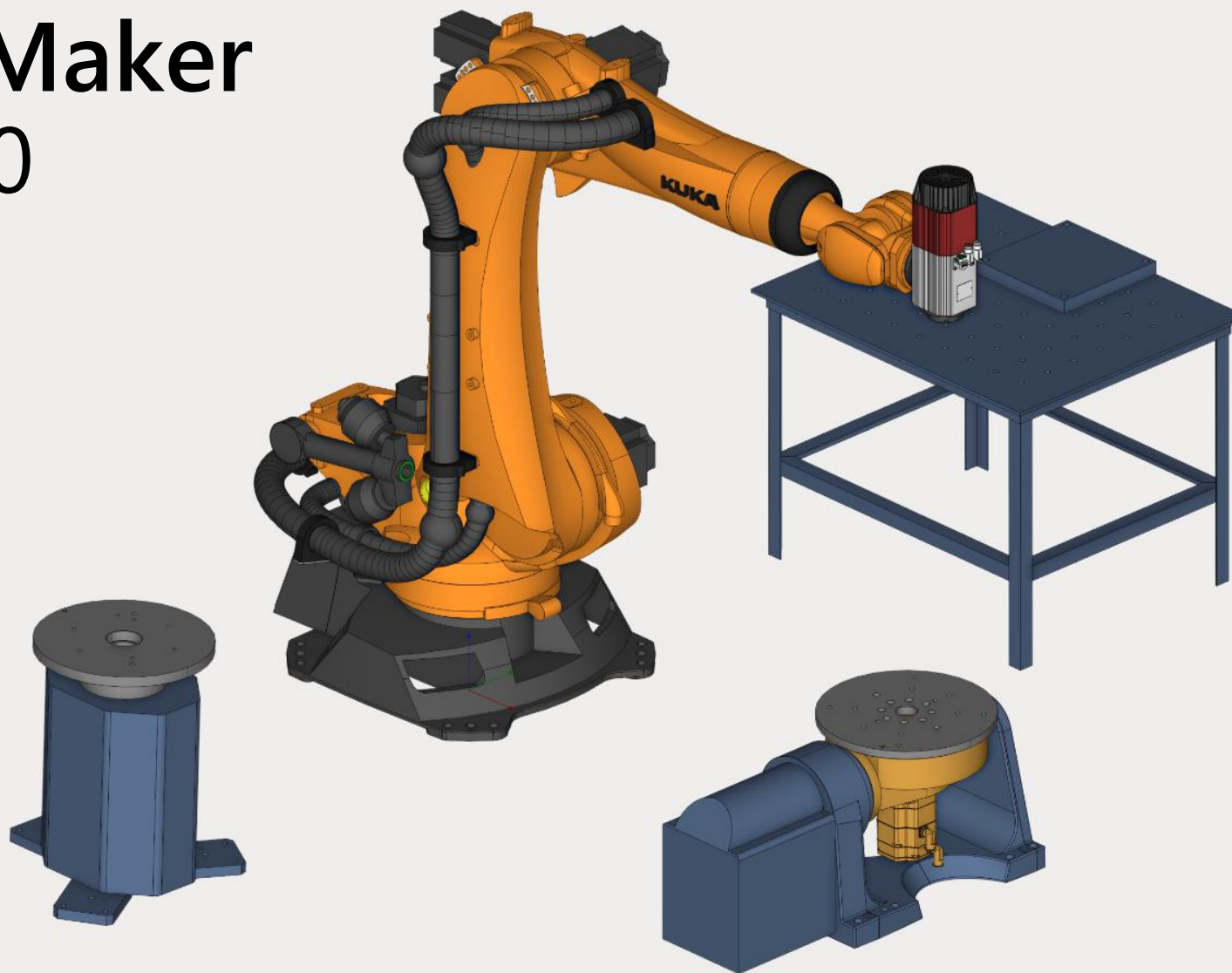

Simulation

Simulation

 Enable collisions detection

► Meshes generation parameters

Start processing simulation

KR120 R2700 HA Home Demo

A1 0 -185 185

A2 -90 -140 -5

A3 90 -120 155

A4 0 -350 350

A5 0 -125 125

A6 0 -350 350

Table (1 axis) Home Demo

E1 0 -1E+09 1E+09

Table (2 axes) Home Demo

E2 0 -135 135

E3 0 -1E+09 1E+09



Close

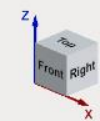

Concept

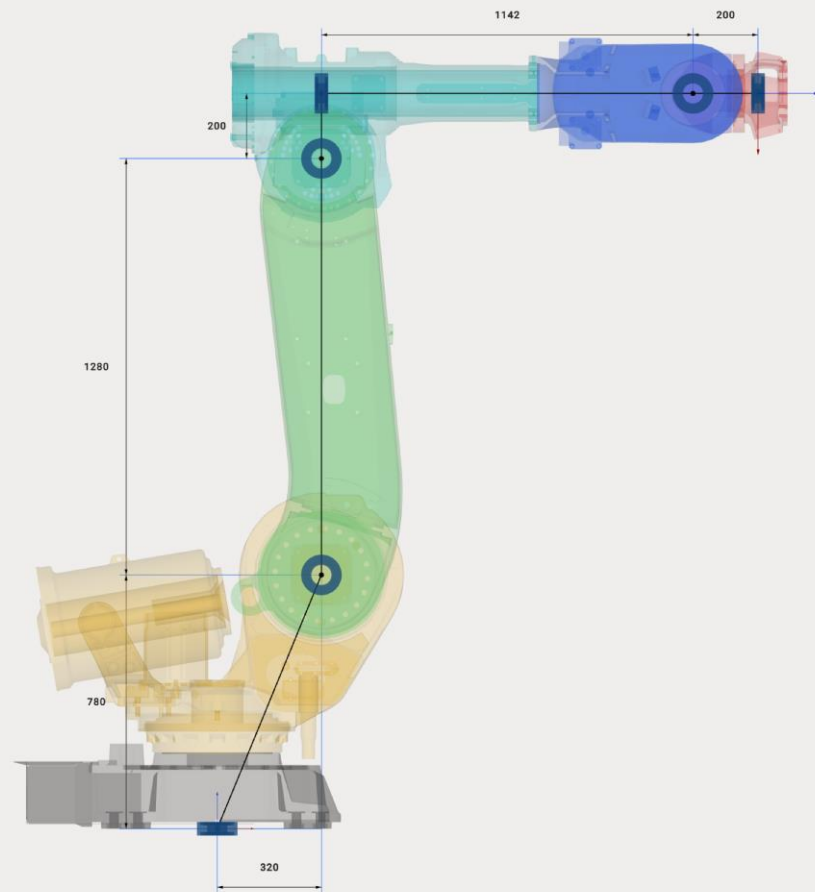
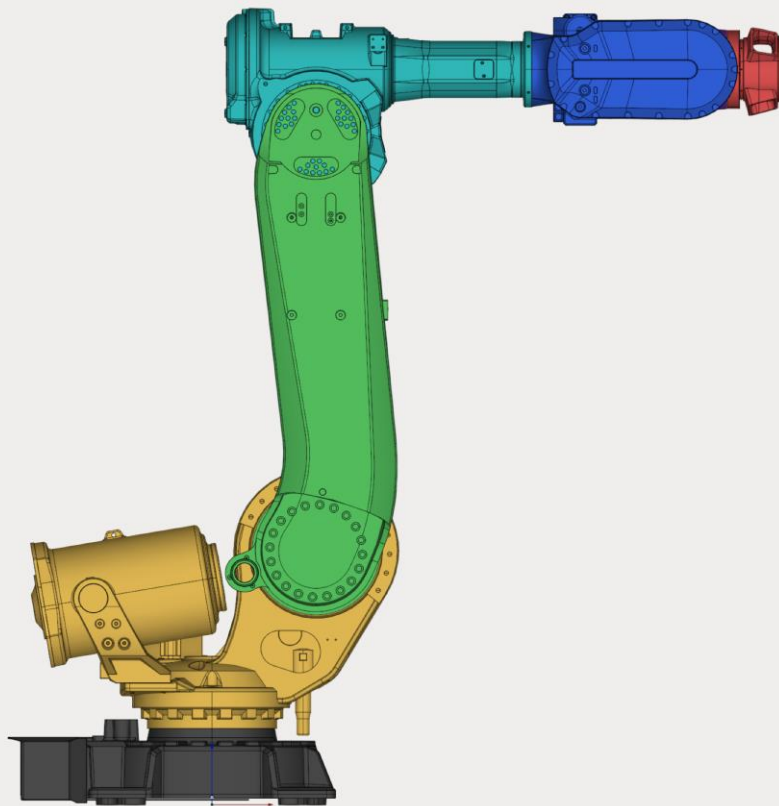
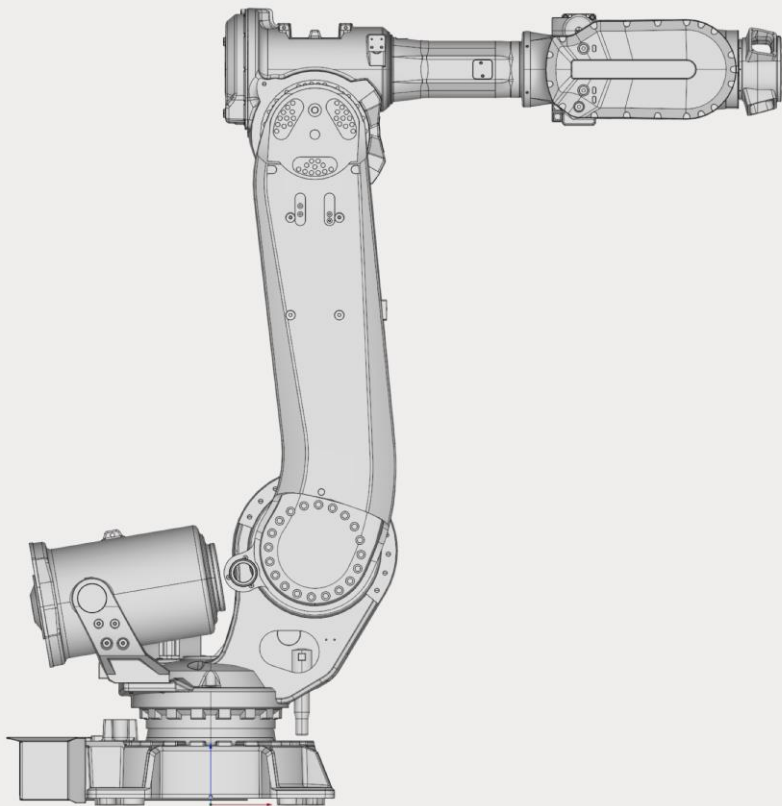

Concept

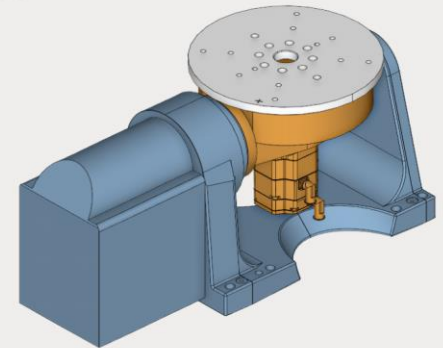
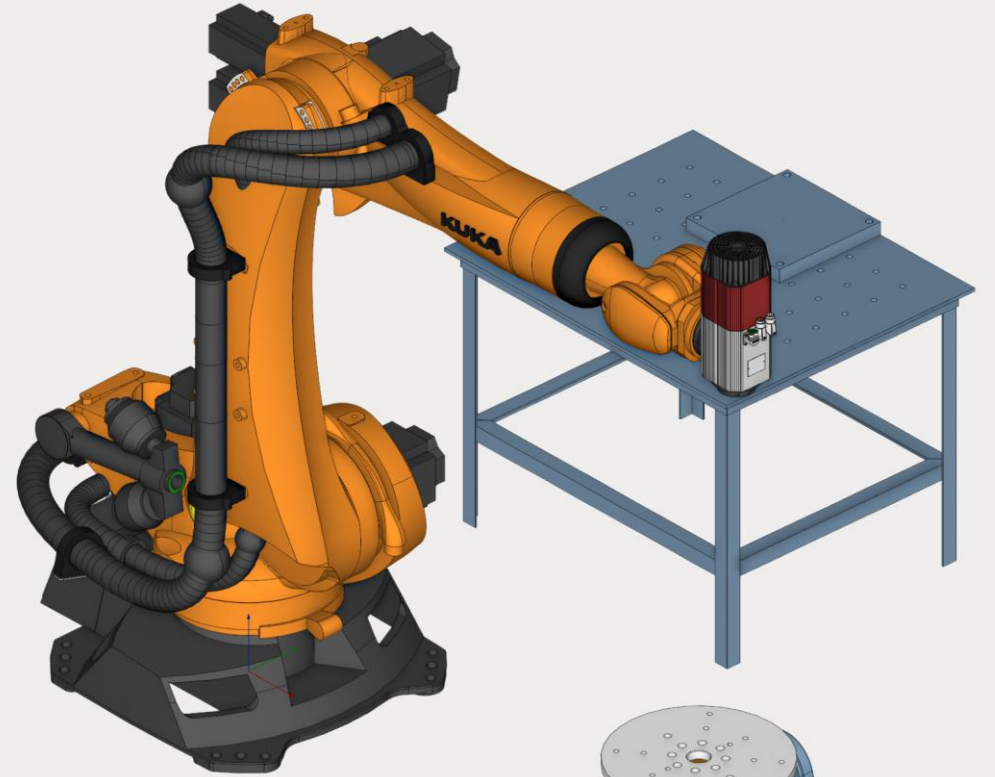
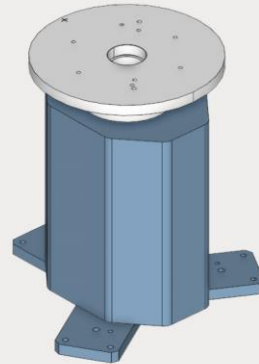
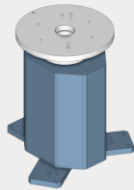
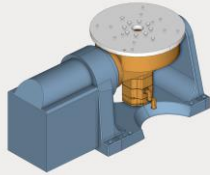

Milling machines

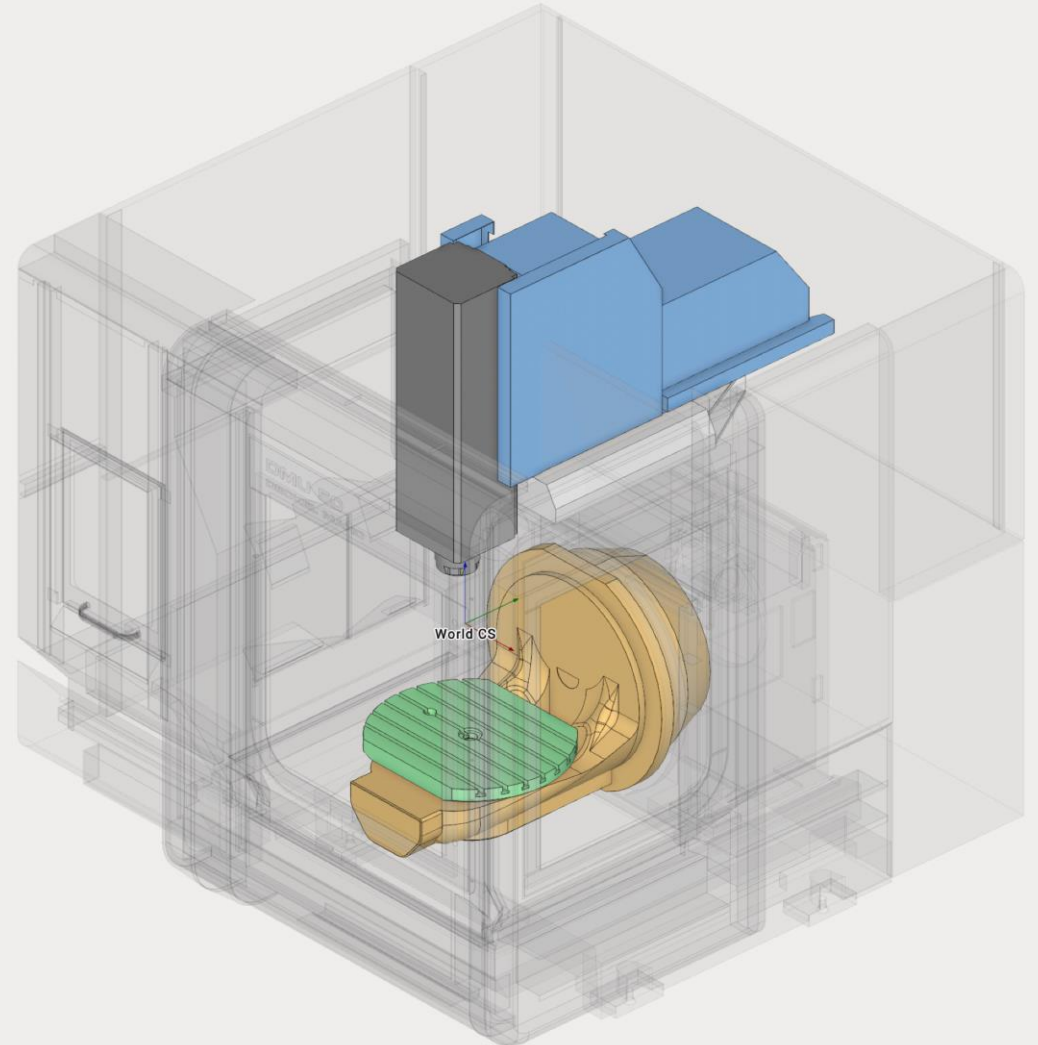
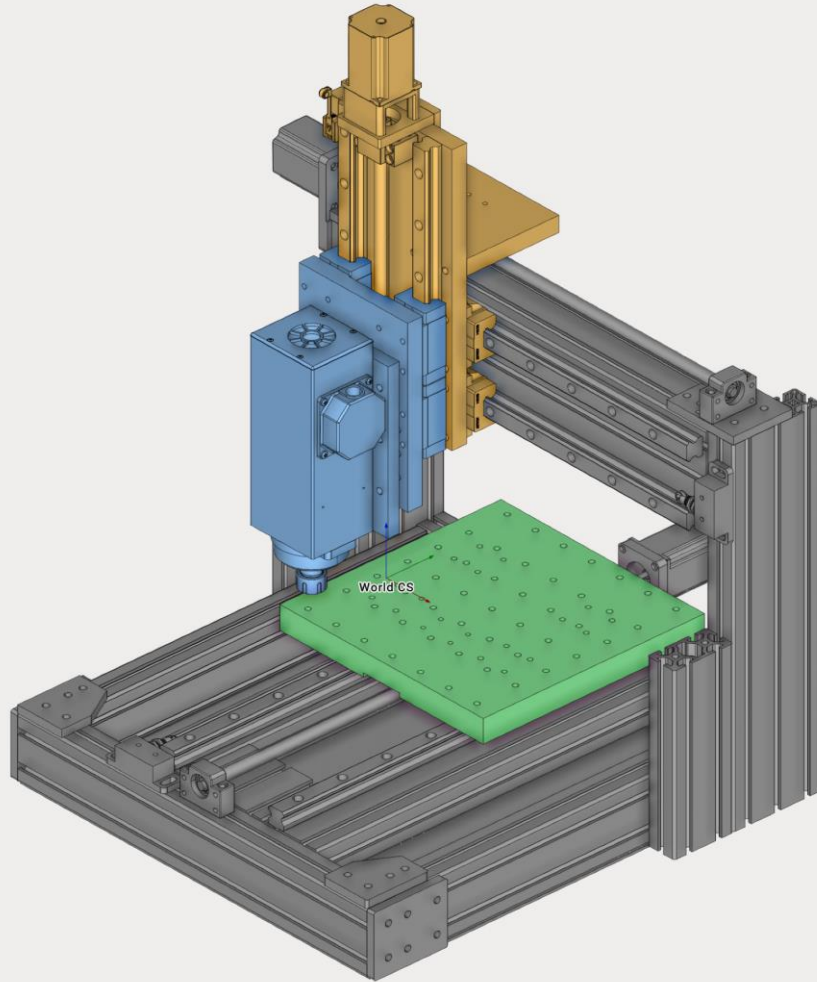

Library

ABB **FANUC** **KUKA** *STÄUBLI*  **TORMACH®**

 **HYUNDAI** **YASKAWA**  **Kawasaki** **DOOSAN**

EPSON **COMAU** *regal robotics* **SIASUN** **EFORT**

 **MITSUBISHI ELECTRIC** **NACHI**  **AUBO** **EVS** **JAKA®**  **集萃智造**
JITRI INTELLIGENT MANUFACTURING

 **HAN'S ROBOT**  **UNIVERSAL ROBOTS**  **DOBOT**

700 ready-to-use mechanisms

TCP Calibration

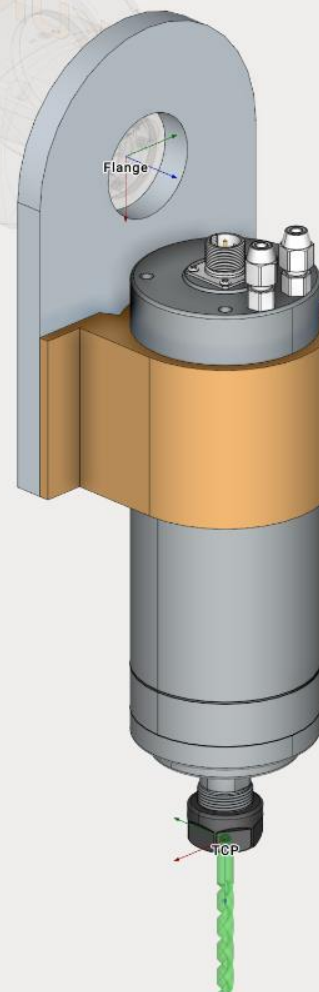

Model

Calibration

314.7422 X -90 A

0 Y 0 B

62.73891 Z -90 C

Tool overhang 0

 Tool along X-axis Visualize tool Transform end effector 3D model with TCP

Automatic data transfer

Sync



Download MachineMacker App for scan QR-code and data transmission directly from the robot.

GET IT ON
Google PlayDownload on the
App Store

Cancel

Apply

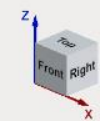

TCP Calibration

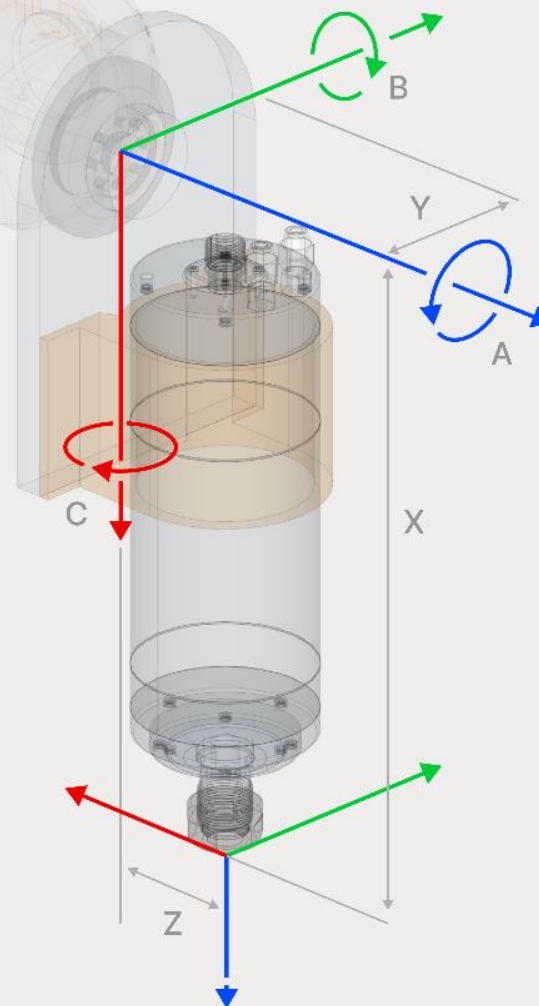

Model

TCP

Style

Calibration

314.7422	X	-90	A
0	Y	0	B
62.73891	Z	-90	C
Tool overhang		0	

- Tool along X-axis
- Visualize tool
- Transform end effector 3D model with TCP

Automatic data transfer



Download MachineMacker App for scan QR-code and data transmission directly from the robot.



Cancel

Apply

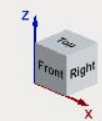

TCP calibration app

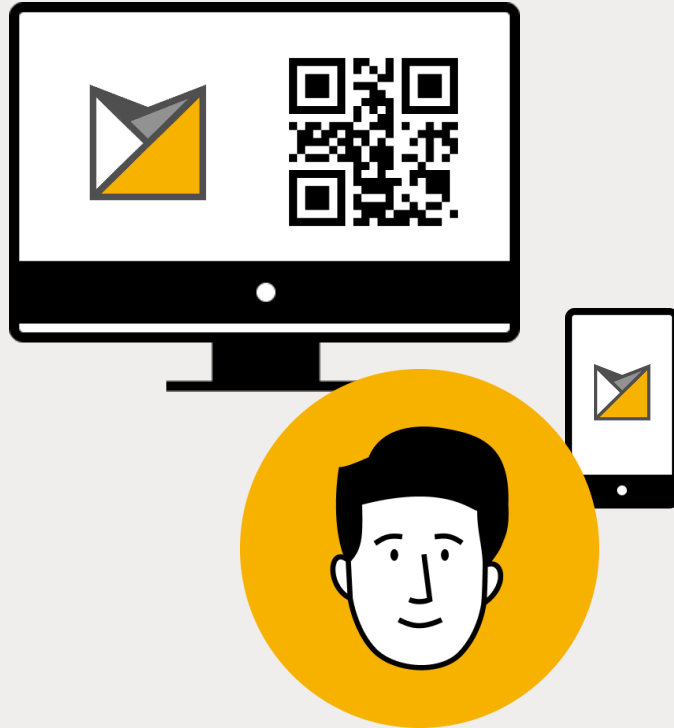

Model

TCP

Style

Calibration



314.7422 X -90 A

0 Y 0 B

62.73891 Z -90 C

Tool overhang 0

- Tool along X-axis
- Visualize tool
- Transform end effector 3D model with TCP

Automatic data transfer

Sync

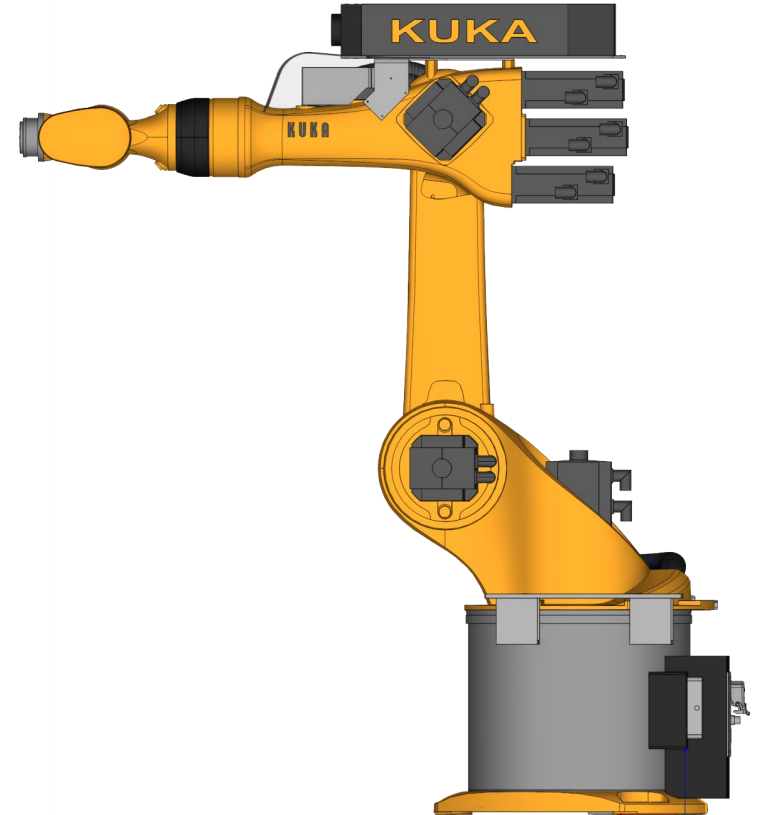

Download MachineMacker App for scan QR-code and data transmission directly from the robot.



TCP

calibration app

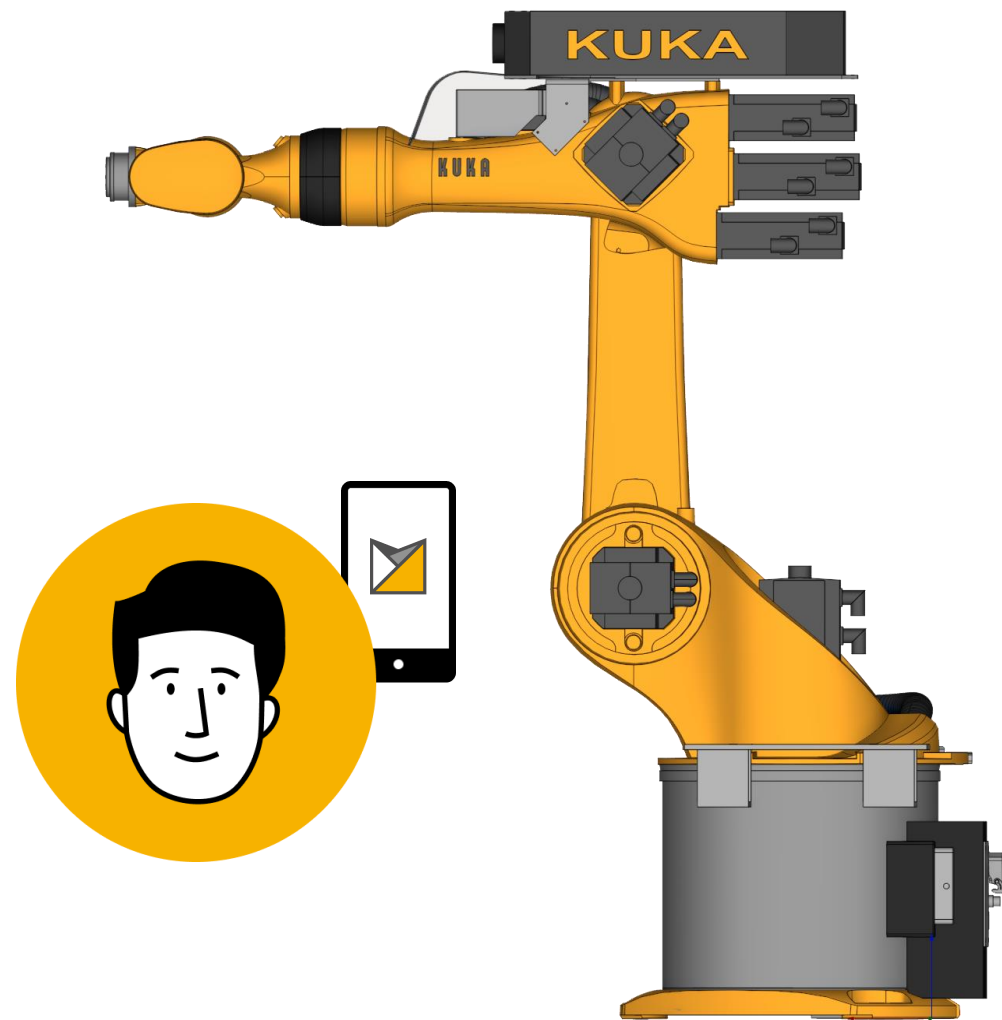

TCP calibration app

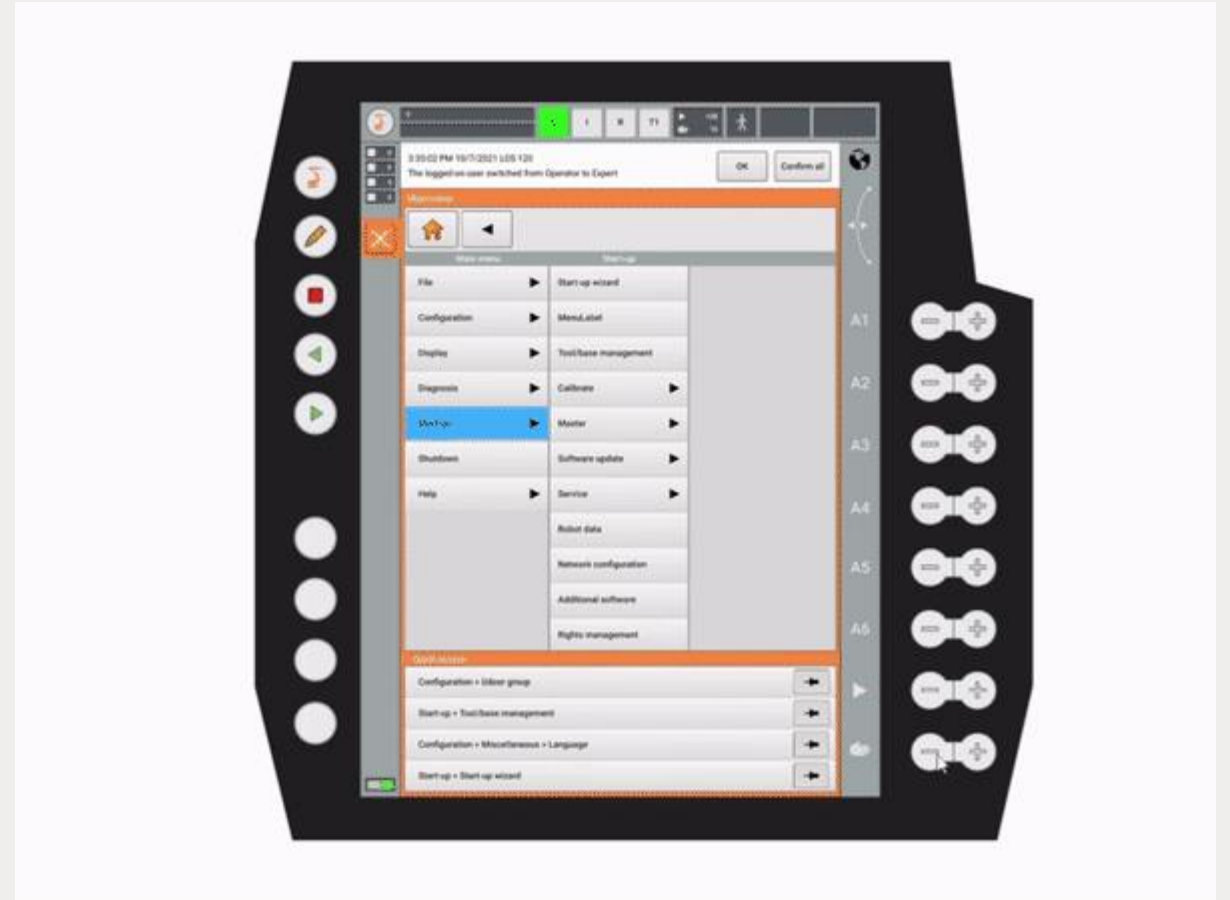
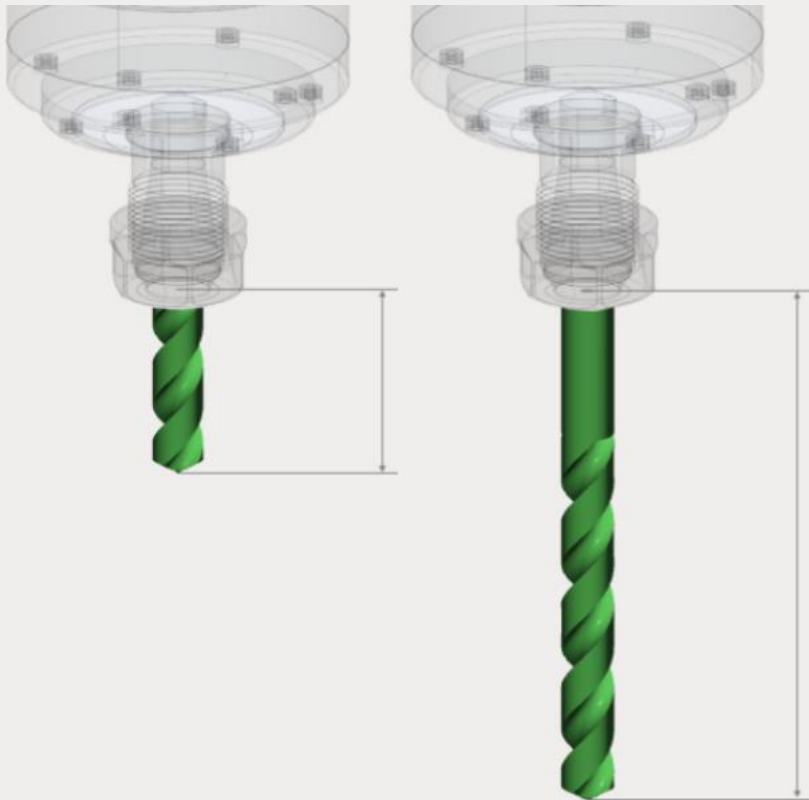

TCP

calibration app

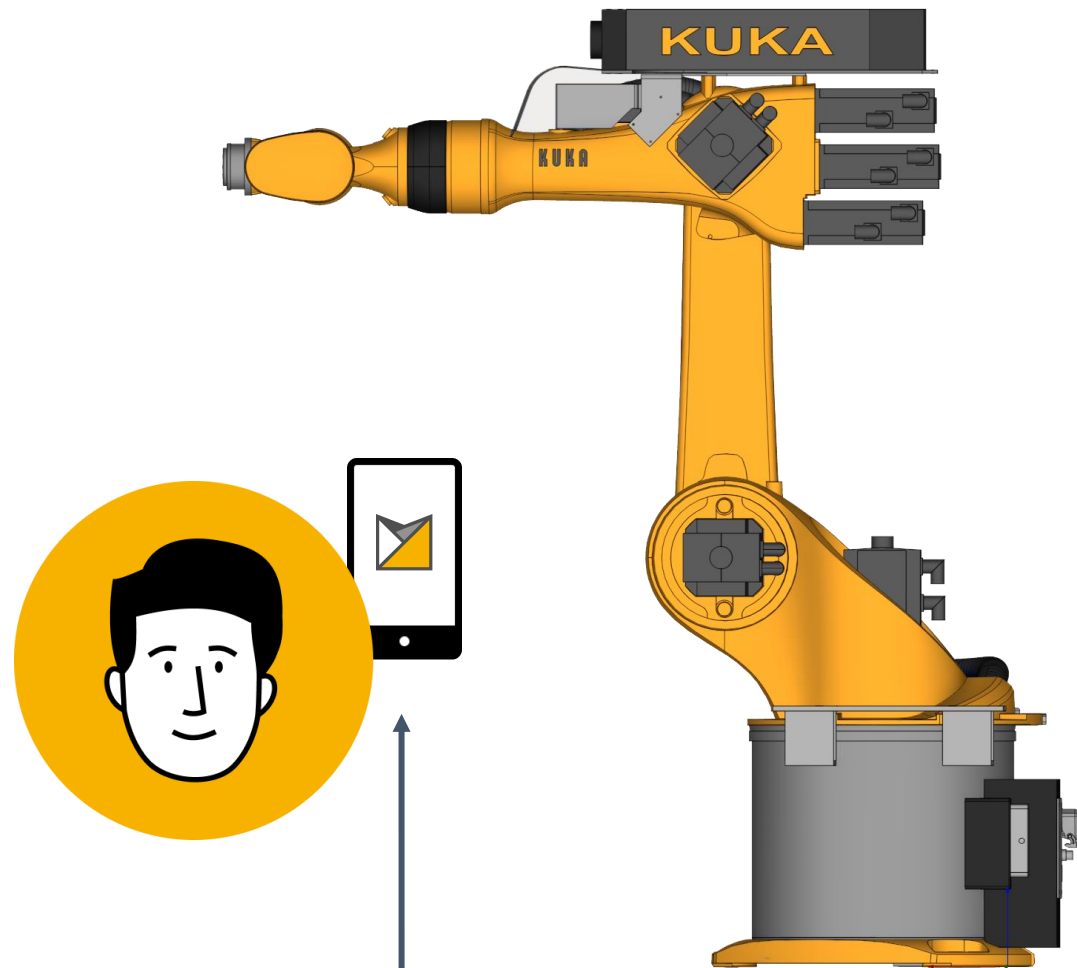

Calibrate TCP
(short tool) x y z
(long tool) x y z

TCP calibration app

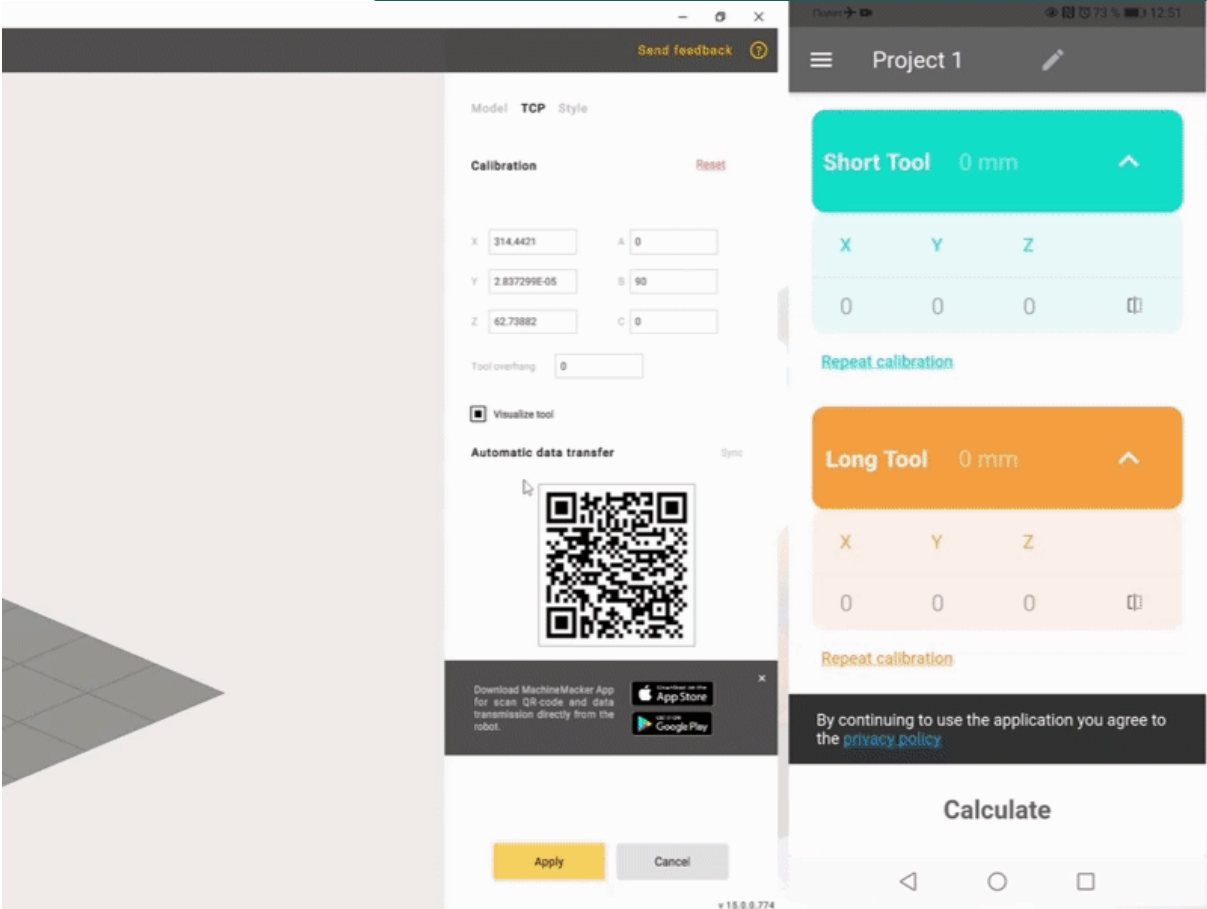

TCP calibration app



TCP data: X Y Z A B C

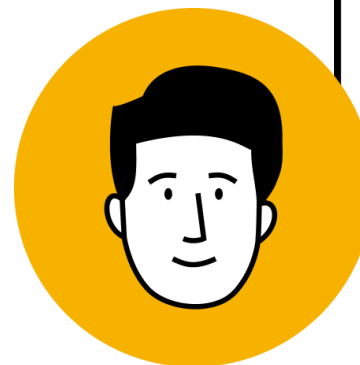

Calibrate TCP
(short tool) x y z
(long tool) x y z

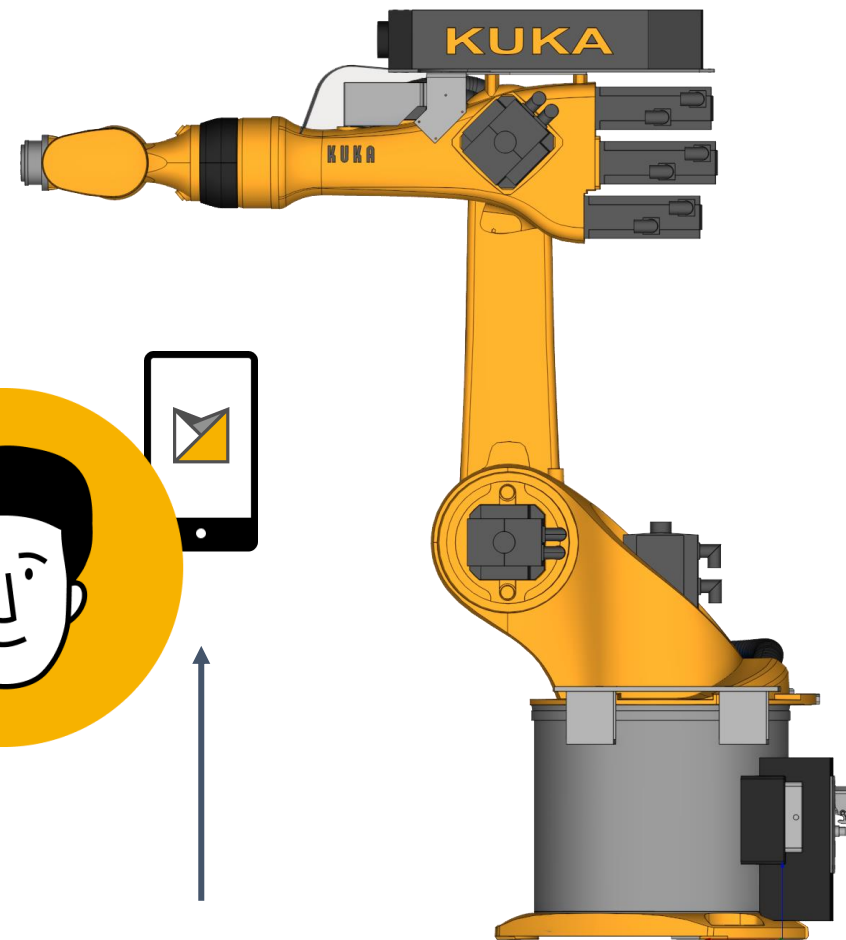

TCP calibration app

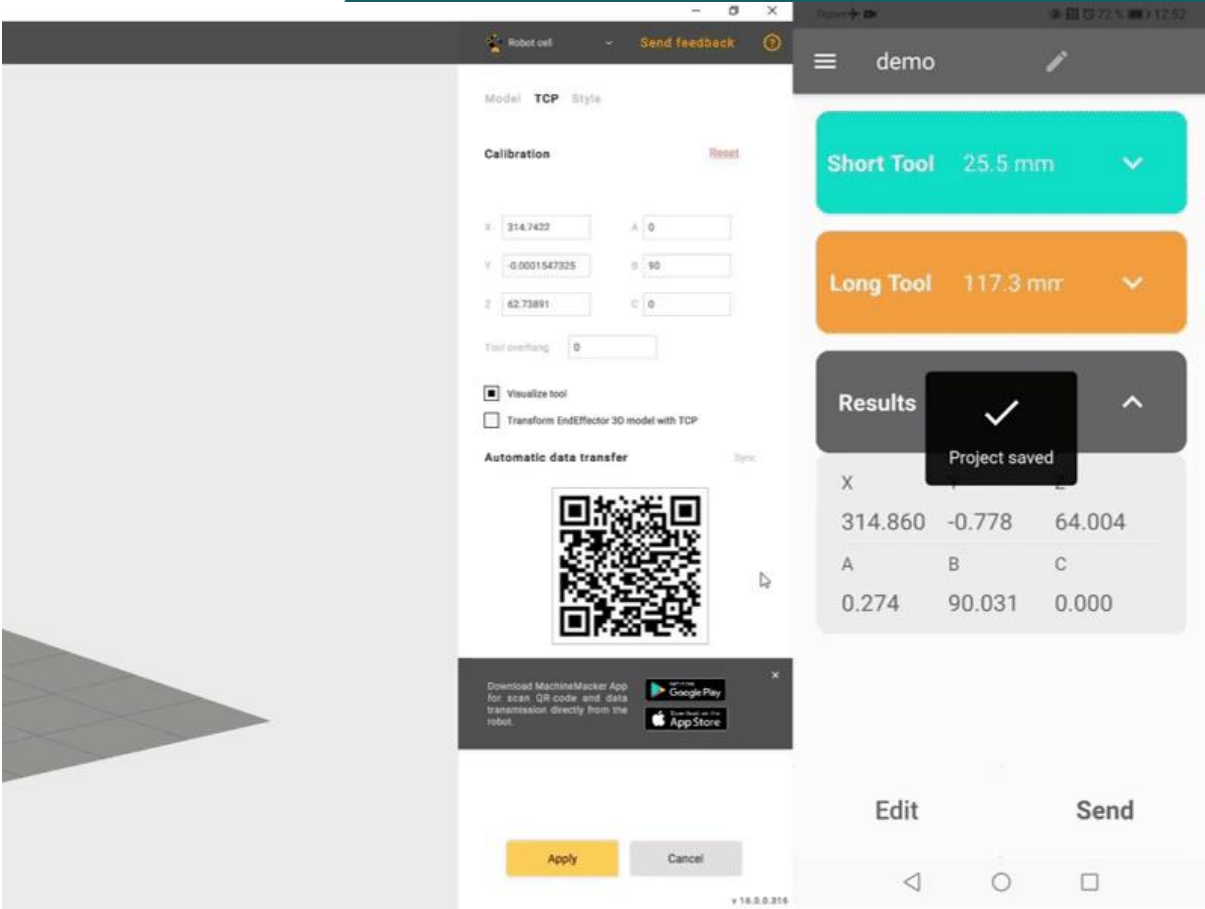

Customers love it

4 000 MachineMaker users worldwide



New features

- Optional axes
- Turn-Mill machines
- Swiss-type machines
- Interactive Simplifier

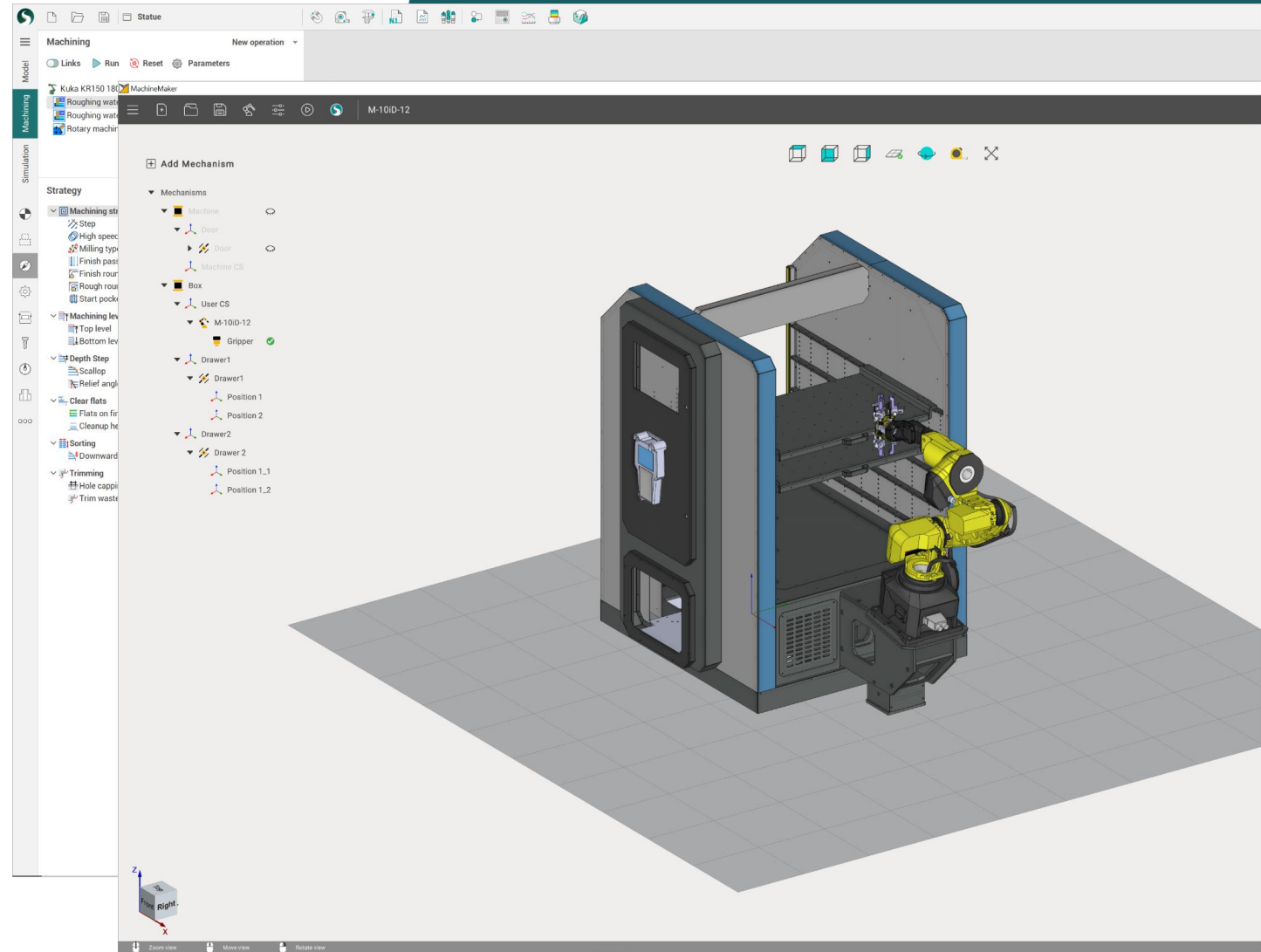

History

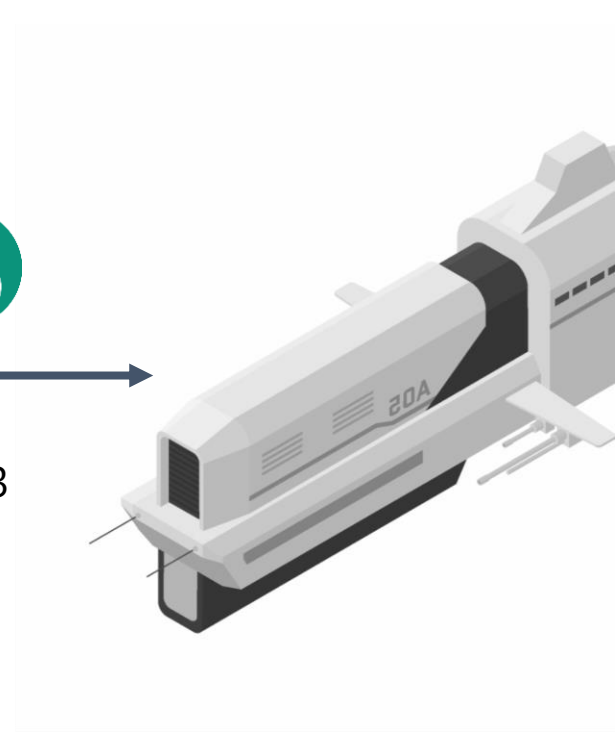
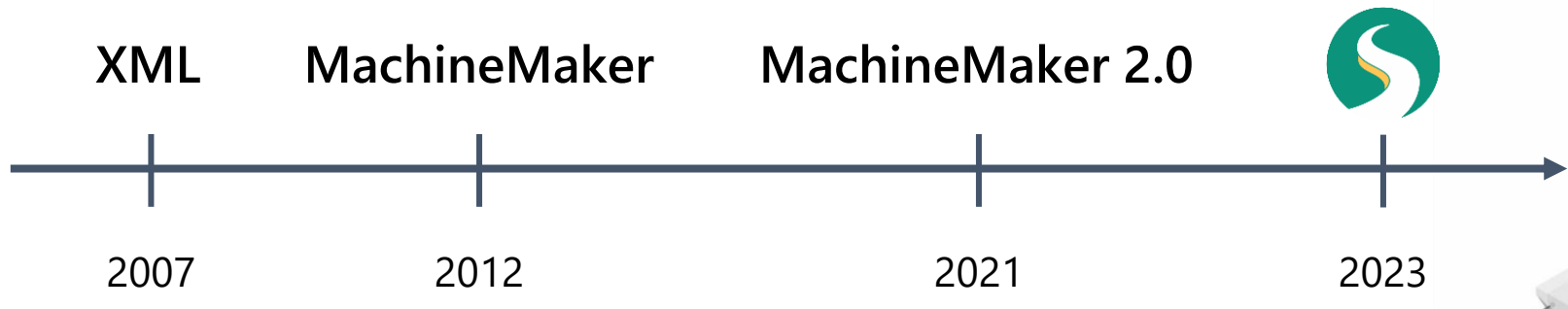

Dreams:

MachineMaker for the Machine Makers



Real robot cell



Digital twin

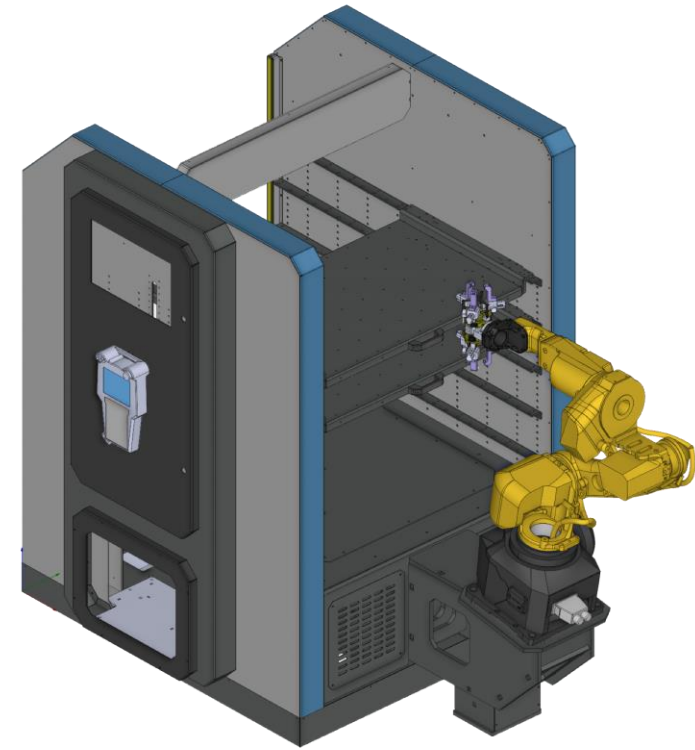

Dreams:

MachineMaker for the Machine Makers

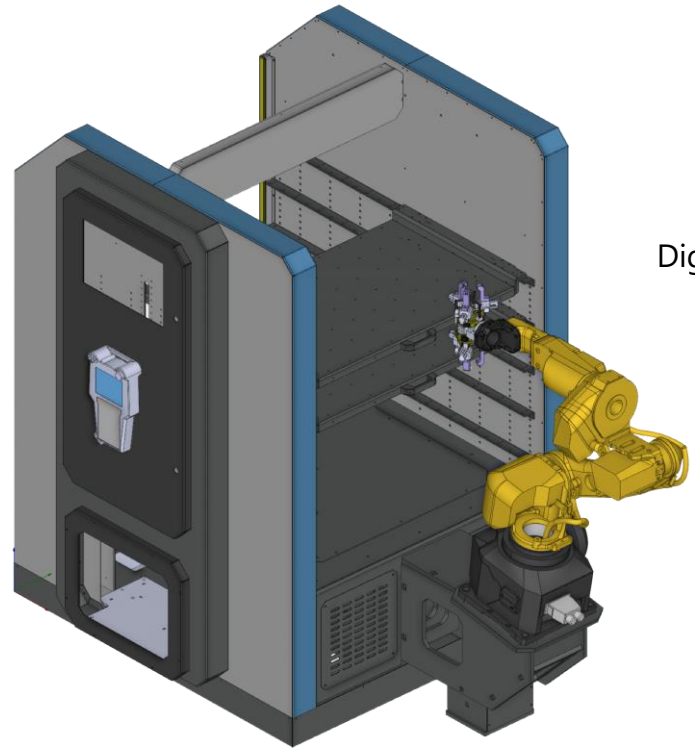

Digital twin



Real robot cell



Dreams:

Robot cell creator

- 700 ready-to-use mechanisms
- 20 vendors
- Create any custom mechanisms

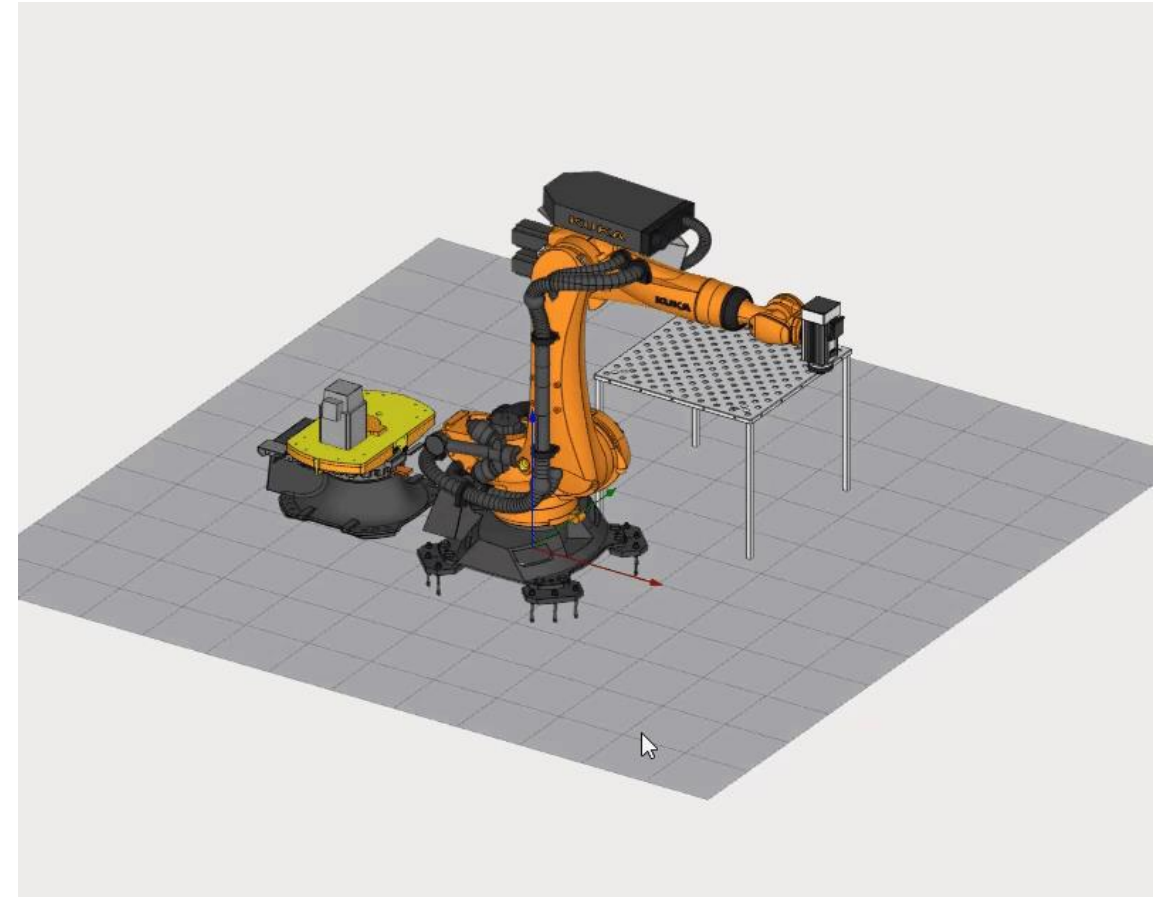

Dreams: VR

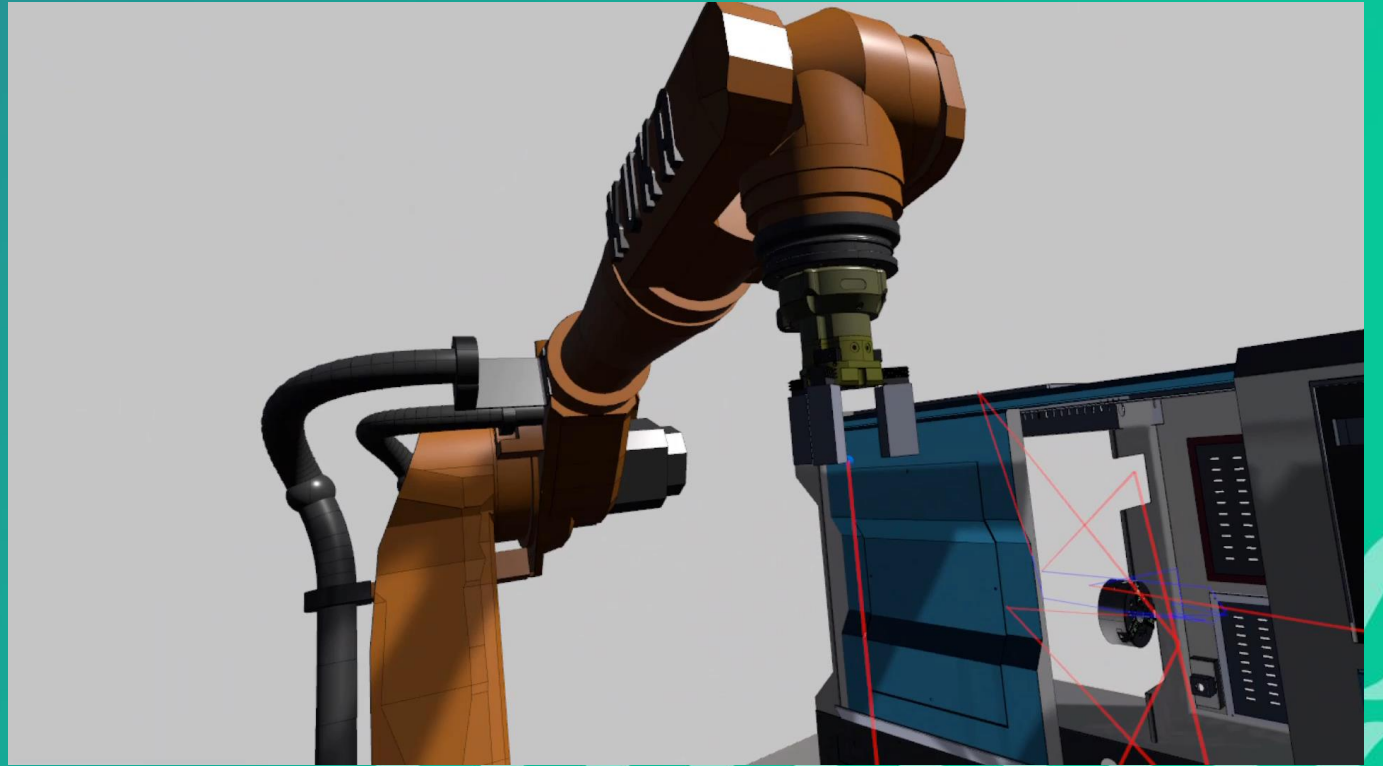



SPRUTCAM X
WORLD CONFERENCE
2023

**The History and
Future of MachineMaker**